

SHORT WALER

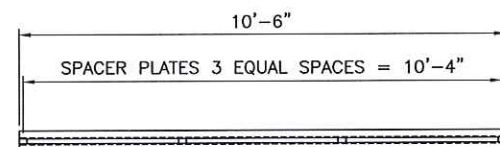

LONG WALER

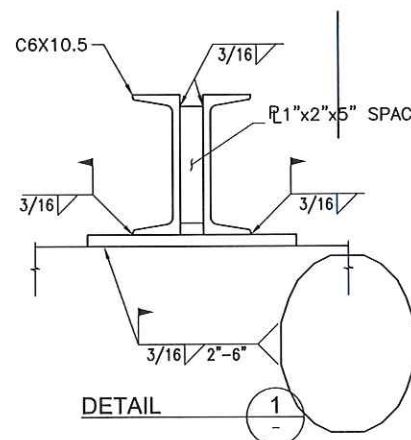

WATER DETAIL

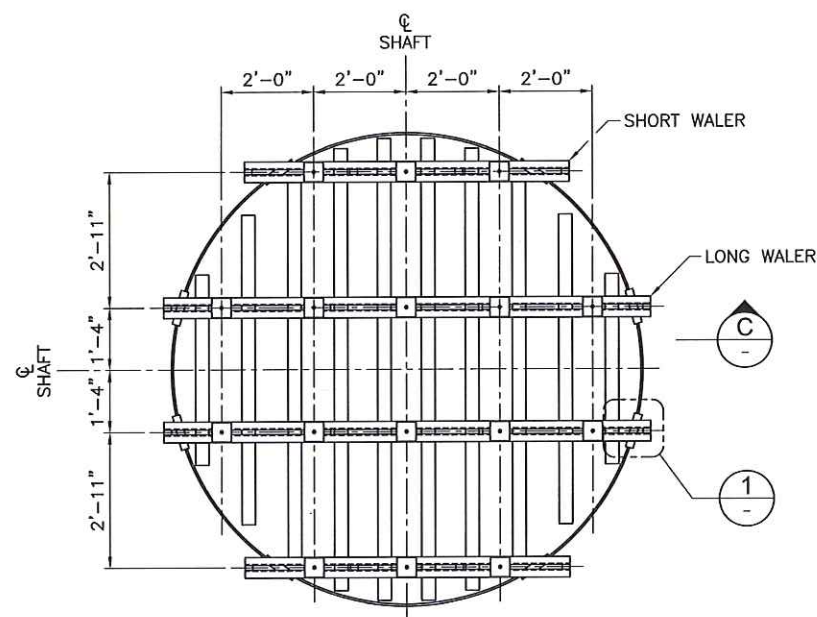

CASING PLUG SOFFIT FORM
GENERAL ARRANGEMENT

- HANGER ASSEMBLY BY DAYTON SUPERIOR
- B12-1/2" COIL ROD
 - B11 HEAVY FLAT WASHER TOP AND BOTTOM
 - B25 or 2 EACH B-13 COIL NUT TOP AND BOTTOM

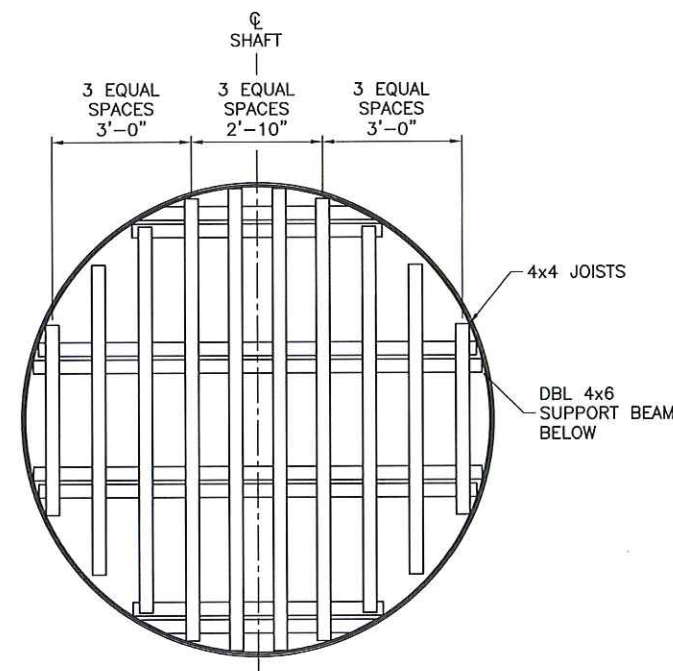

CASING PLUG SOFFIT FORM
TIMBER FRAMING LAYOUT

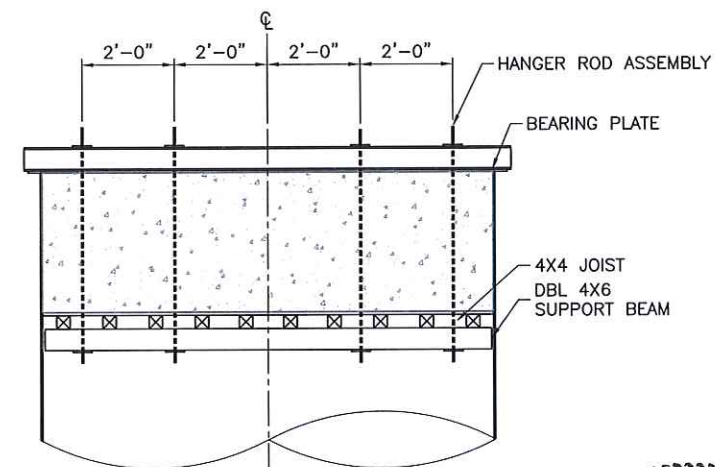

SECTION C

McNARY BERGERON & ASSOCIATES LLC
F-18682



DESIGNED		REVISIONS		SPECIFICATIONS AND REFERENCE DRAWINGS	
RENATO RAVAZZOLO	12 DEC 2016	REV	DATE	DESCRIPTION	BY
DRAWN	DAVID HETZEL	0	12 DEC 2016	FOR CONSTRUCTION	RR
CHECKED	DANNY GILBERT	1	30 JAN 2017	AS NOTED	RR
APPROVED	W. SCOTT McNARY	2	6 APR 2017	GENERAL REVISION	AB
		3	08 SEP 2017	NO CHANGE TO THIS SHEET	AB



US 181 HARBOR BRIDGE
REPLACEMENT PROJECT
500 NORTH SHORELINE BOULEVARD, SUITE 500
CORPUS CHRISTI, TX 78401

N1 AND S1 TOWER FOOTINGS
GENERAL DETAILS
TEMPORARY BRACING
SECTIONS AND DETAILS SHEET 1

FLATIRON JOB No. 2835 DRAWING No. 2835-SUB-TCD-006

SUPERSEDES PRINTS OF THIS DRAWING WITH REVISIONS PREVIOUS TO 3